

PERMIT WILL BE:
PICKED UP ☒, MAILED TO OWNER____,
MAILED TO INSTALLER_____

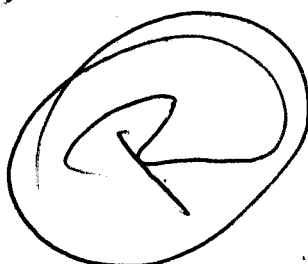

AP1910-0154

RX. NO. 85782
DATE PD. 6-22-87
DATE ISD. 6-24-87
DATE EXP. 9-24-87
COUNTY Potter

AMARILLO BI-CITY-COUNTY HEALTH DEPARTMENT
APPLICATION FOR PERMIT TO INSTALL, MODIFY OR ALTER A SEPTIC SYSTEM
IN POTTER OR RANDALL COUNTY

Name of Owner/Developer: John C Hill
Phone: (806) 383-1820 Mailing Address: 104 Range Trail

Name of Septic System Installer: Kenny Drum
Phone: (806) 799-7055 Mailing Address: 4008 33rd Lubbock 24a

Mailing Address of Proposed Septic System: _____

Property Description as recorded in tax records: (this information may be obtained by contacting the Potter-Randall Appraisal District at 358-1414)

Lot 6, BLOCK 28, Rolling Hills Unit 3
A SUBDIVISION OF 175.69 Acres in Section 220
Block 2, AB + M Survey
Potter County, Texas

Direction to Job Site: Use exact car odometer readings from permanent land mark (i.e. bridge or road intersection) or make a drawing in space provided.

THE FOLLOWING INFORMATION MUST BE COMPLETED BEFORE PERMIT WILL BE ISSUED.

Perculation Rate 6-15 (100 Range) (State Source) (Tank Replacement)
House ☒ Mobile Home _____ Business _____ (Check One) only
Number of Bedrooms 3 Living area 1989 Square Feet.
Tank Size 500 Gallon. Tank Material fiberglass
Lateral Lines: P.V.C. & Gravel ☒ Graveless Pipe _____ (Check One)
Trench Width _____ Inches. Trench Length _____ Feet.
Total Absorption Area _____ Square Feet.

Will you need to exceed 3 feet or install step downs concerning trench depth? _____

Are you familiar with all provisions of Texas Construction Standards for private sewage facilities? yes

(OVER)

7-13-87

Use the space provided for a drawing of proposed septic system layout.
Must include the following:

1. Well location and proximity of adjacent (neighbors) wells showing distance from tank and lateral lines.
2. Proposed water lines.
3. Proposed home/trailer site.
4. Any property lines within 10 feet of septic system.
5. Out buildings.
6. Fences.
7. Length of all lines, solid and perforated.
8. Existing or abandoned septic systems.
9. Show distance from streams, ponds, lakes or flood plain high water mark.

ALL PORTIONS OF THE SOIL ABSORPTION FIELD MUST BE LEVEL.

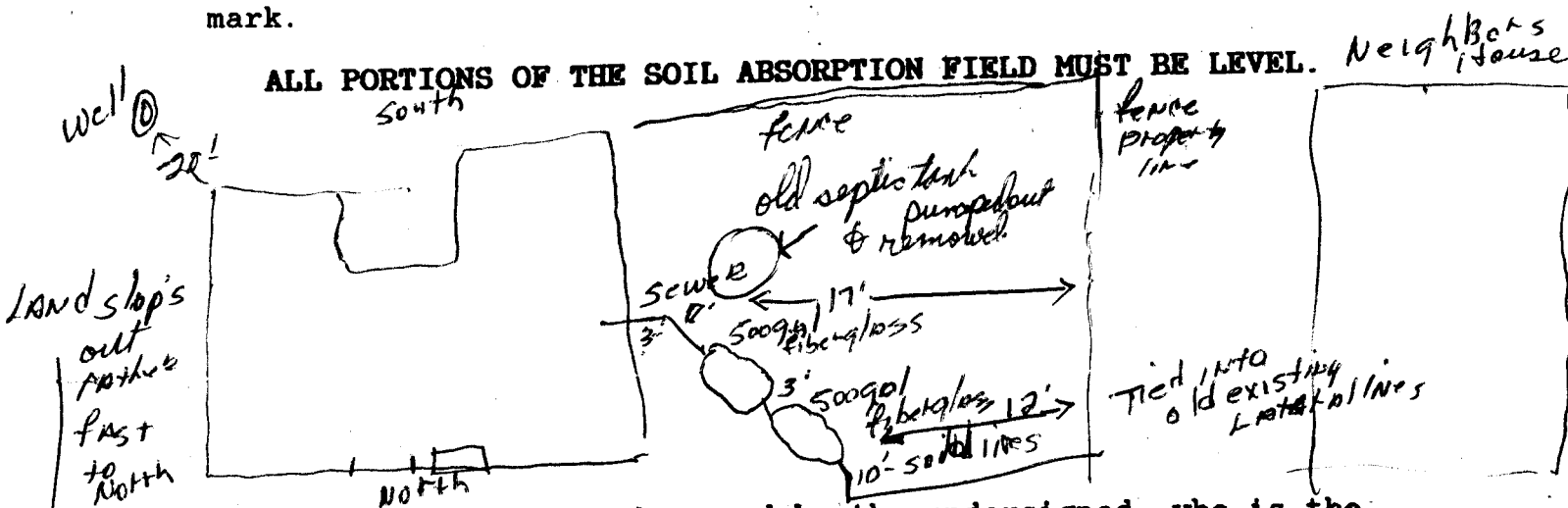

It is hereby stipulated and agreed by the undersigned, who is the applicant for such permit, that in consideration of the issuance of such permit, the said applicant will conform with all the provisions of Texas Construction Standards for Private Sewage Facilities, and will all orders that may be made from time to time by the Health officer, and it is further stipulated and agreed that the Health Officer, or his representative, is granted permission to inspect the premises and system of the undersigned insofar as it pertains to the provisions of Texas Construction Standards for Private Sewage Facilities and that the information given herein is true and correct.

IT IS FURTHER AGREED THAT AN INSPECTION BY THE HEALTH DEPARTMENT MUST BE MADE BEFORE BACKFILL IS DONE, AND A FEE OF \$25.00 WILL ACCOMPANY THIS APPLICATION FOR PERMIT. THIS PERMIT SHALL BE VALID FOR A PERIOD OF 90 DAYS.

APPLICANT'S SIGNATURE

PLEASE RETURN THIS APPLICATION TO:
Amarillo Bi-City-County Health Department
P.O. Box 1971
Amarillo, Texas 79186

DATE OF APPROVAL 7-13-87

BY:

SANITARIAN'S SIGNATURE

SEPTIC TANK INSPECTION FORM

NAME OF OWNER: John C. Hill

ADDRESS: 102 Range Trail

NAME OF CONTRACTOR: Kenny Drum

ADDRESS: 4008 W 33rd Lubbock TX

ADDRESS OF PROPOSED SYSTEM: 102 Range

SUB DIVISION: Rolling Hills Unit 3 BLOCK #: 28 LOT: 6

MINIMUM SAFE DISTANCE IN FEET.

	Septic Tank	Soil Absorption System
Water Wells, Cisterns and Pump Suction Pipes	*50 <input checked="" type="checkbox"/>	**150 <input type="checkbox"/>
Streams and Ponds	50 <input type="checkbox"/>	75 <input type="checkbox"/>
Foundation Walls of Structures	5 <input checked="" type="checkbox"/>	15 <input type="checkbox"/>
Property Lines	10 <input checked="" type="checkbox"/>	10 <input type="checkbox"/>
Public Water Supply	5 <input type="checkbox"/>	10 <input type="checkbox"/>
Other <input type="checkbox"/>	<input type="checkbox"/>	<input type="checkbox"/>

*May be within 20 Feet if tanks are designed for submergence (reinforced monolithic concrete or equal) and if influent and effluent lines to septic tank are watertight.

Percolation Rate
Minutes Per Inch: —

Total Absorption Area: —

No. of Bedrooms: 3

Trench Width: —

Tank Capacity: 1000

Trench Depth: —

No. of Tanks: 2

Trench Length: —

Tank Made Of: Plastic

Lines Made Of: —

Tank Soil Cover: 12"

Inches Gravel: —

Riser For Portals: yes

Cubic Yards Gravel: —

Water System: well

Date(s) of Inspection: July 1987

SANITARIAN: Shawn Riehl

DATE OF APPROVAL: 7-13-87



TO Existing Absorption
Field.

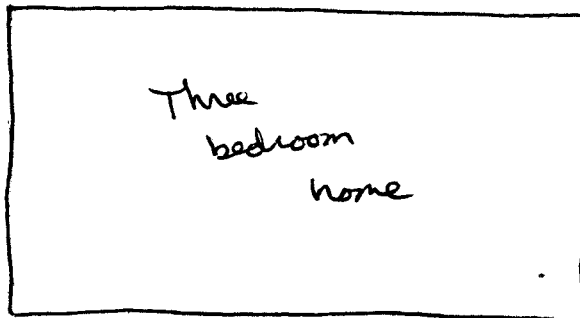
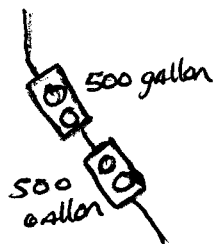

well